



GRUPPO SOSTA art. 313

Gruppo Sosta - acciaio inox AISI 316L
Belay Station - Stainless steel AISI 316L
Desquelgue – inoxidable AISI 316L
Ensemble - inox AISI 316 L

MADE IN ITALY



Art. 313

2 ROCK Ø12 + 2 catene ritorte +
 1 anello Ø10 + 2 R5000

Peso Weight Peso Poids 580 g



Inserire la corda in entrambi i moschettoni
 Put the rope in both carabiners
 Inserte el cable en ambos mosquetones
 Insérez la corde dans les deux mousquetons

OK!

Art. 313

Nomenclatura Nomenclature

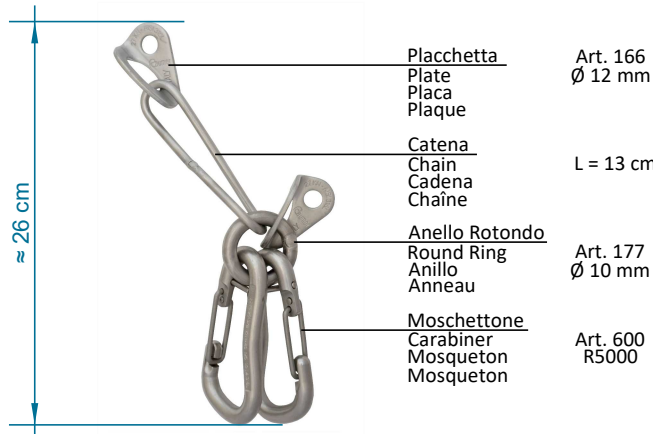

Placchetta
 Plate
 Placa
 Plaque
 Art. 166
 Ø 12 mm

Catena
 Chain
 Cadena
 Chaîne
 L = 13 cm

Anello Rotondo
 Round Ring
 Anillo
 Anneau
 Art. 177
 Ø 10 mm

Moschettone
 Carabiner
 Mosqueton
 Mosqueton
 Art. 600
 R5000

Vedi le schede tecniche dei singoli prodotti: art. 600 e art. 166
 See the technical data sheets of the songol products: art. 600 and art. 166
 Ver las fichas técnicas de los productos individuales: art. 600 y art. 166
 Voir les fiches techniques des différents produits: art. 600 et art. 166

Resistenza effettiva della placchetta
 Effective strenght of the plate
 Resistencia efectiva de la placa
 Résistance effective de la plaque

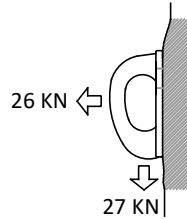

Resistenza effettiva del moschettone
 Effective strenght of the carabiner
 Resistencia efectiva del mosqueton
 Résistance effective du mosqueton

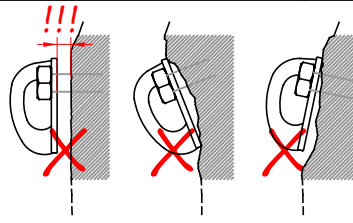
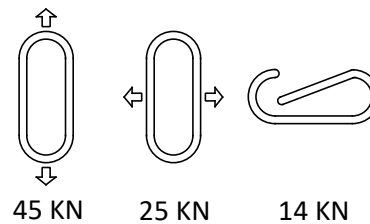

**WARNING,
DANGER!!!**

Calata regolata dal basso
 Abseil descent
 Descenso en rápel
 Descente en moulinette



Corda
 Rope
 Cuerda
 Corde

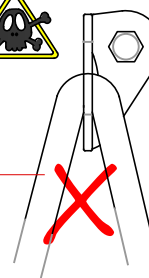

Non inserire la corda nella catena per la Calata regolata dal basso
 Do not put the rope in the chain for the Abseil descent
 No ponga la cuerda en la cadena por hacer Descenso en rápel
 Ne pas mettre la corde dans la chaîne pour Descente en moulinette

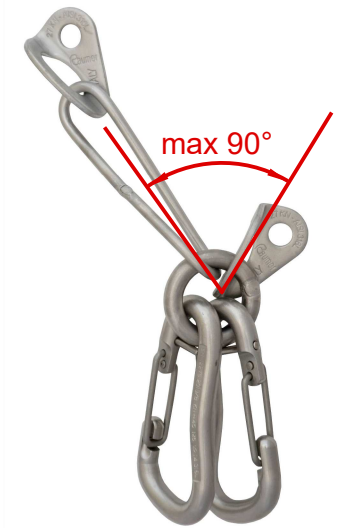

Orientare la placchetta nella direzione del carico
 Orient the plate in the direction of the load
 Orientar la placa en la dirección de la carga
 Orienter la plaque dans la direction de la charge

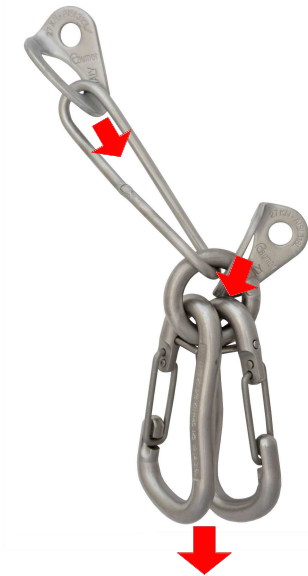

- USARE IN AMBIENTE INDOOR O IN PARETI ARTIFICIALI ALL'APERTO
 - INDOOR USE OR USE IN ARTIFICIAL OUTDOOR WALLS
 - UTILISATION À L'INTÉRIEUR OU IN ARTIFICIEL MURS À L'EXTÉRIEUR
 - USO INDOOR O EN PAREDES EXTERIORES ARTIFICIALES